

## ASC150X-2" DC Current Transducer

- Split core CT for easy Installation
- 24Vdc Supply
- 2 year warranty as standard
- CE compliant
- Connect directly to PLC

### APPLICATION

- DC current monitoring.
- Current signal conditioning.

### TECHNICAL SPECIFICATION

#### INPUT

0 to +/-150Adc

Other current ranges available on request in the range of : +/- 25 to 1500A

#### OUTPUT

4-12-20mAdc into 500 ohms max

Voltage output available on request in the range of: +/- 1 to 10Vdc into 2Kmin.

#### SUPPLY

24Vdc

#### PERFORMANCE

Accuracy: 1% at +/-150A, 3% at 15A

Temp Effect: +0.025% / Deg C

Temp Range: 0 to 40 Deg C

#### PROTECTION

Over current: 10 x rating

Dielectric test: 3750V (Bare bus to Output)

AC Filter:  $\geq 5\text{Hz}$

#### MOUNTING

Weight 1.13Kg

#### CABLE ASSEMBLY

Metal Connector with 8 foot rubber cable\*

OUTPUT = WHITE: (-)  
GREEN: (+)

SUPPLY = BLACK: Common  
RED: +24Vdc

\*Other cable lengths available on request



### Dimensions in mm:

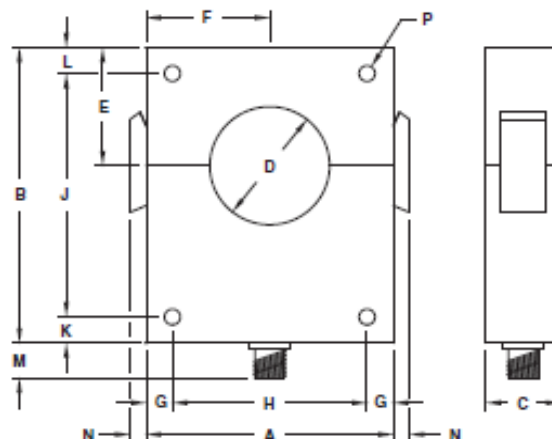

A	B	C	D	E	F	G	H	J	K	L	M	N	P
105	127	32	50.8	50.8	52	11	83	105	11	11	16	8	7

### SAFETY NOTE:

Although the voltage(s) directly connected to this instrument and its internal voltages are low, the cable running through the split core may carry dangerous high voltage. For this reason, this product should be installed by a competent person. If the unit fails to operate correctly then first check if the wiring is correct. Under no circumstance is the unit to be taken apart to gain access to internal circuitry for any reason whilst it has live cable through the split core.