

APM300 48 x 96mm Loop Powered Panel Meter

- ★ Suitable for any elevated process input signal, i.e. 4-20mA; 10-50mA; 1-5mA.
- ★ Loop Drop 2.5Vdc
- ★ Amelec Standard 10 year warranty

An industry standard 1/8th Din display module the 48 x 96mm size

Technical Specifications

General

A self powered display operating on a current loop.
The decimal point on the display is selected by push on
Final display calibration set by zero and span potentiometers

Display

A 3.5 digit LCD display with 12.5mm high characters.
The display is calibrated at the factory to suit the application.
The input signal can be calibrated in the range 0 to 1999.
The decimal point showing as 1.999, 19.99, 199.9 or 1999
Extra hard wired 0's can be supplied i.e. 19990 or 199900

Linearity $\pm 0.1\%$, Integration period 100mS

CMRR 65dB in the range DC to 450Hz

Customer Termination

The customer gains entry at the rear via a Klippon plug and socket pcb connector block.

Panel Fixing Detail

The customers panel cut out hole needs to be 45 x 92mm with the enclosure held into the panel by 2 x screw clamps

Environmental Conditions

Storage Temperature	-40 to 70°C
Operating Ambient	-15 to 55°C
Relative Humidity	5-95 % RH

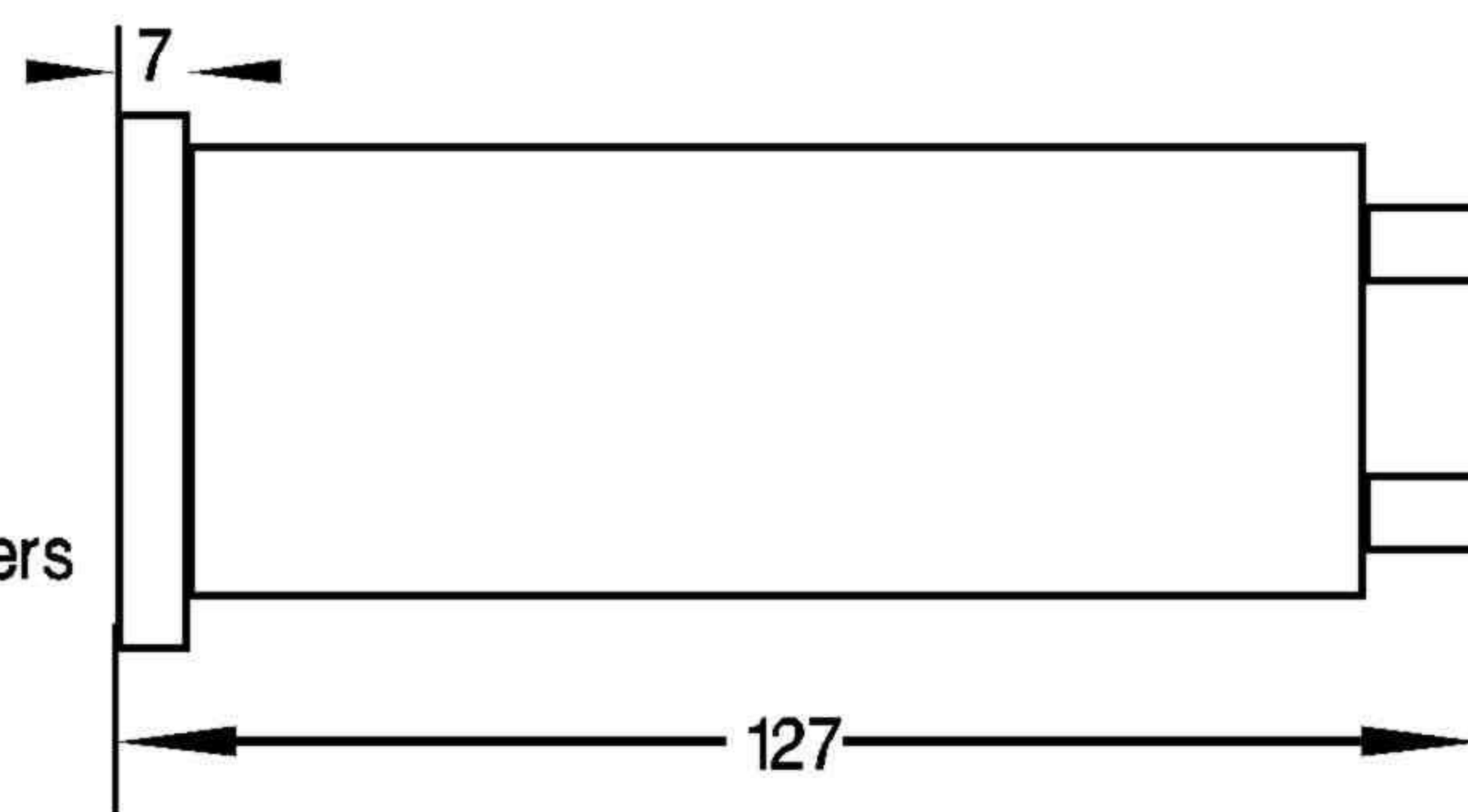
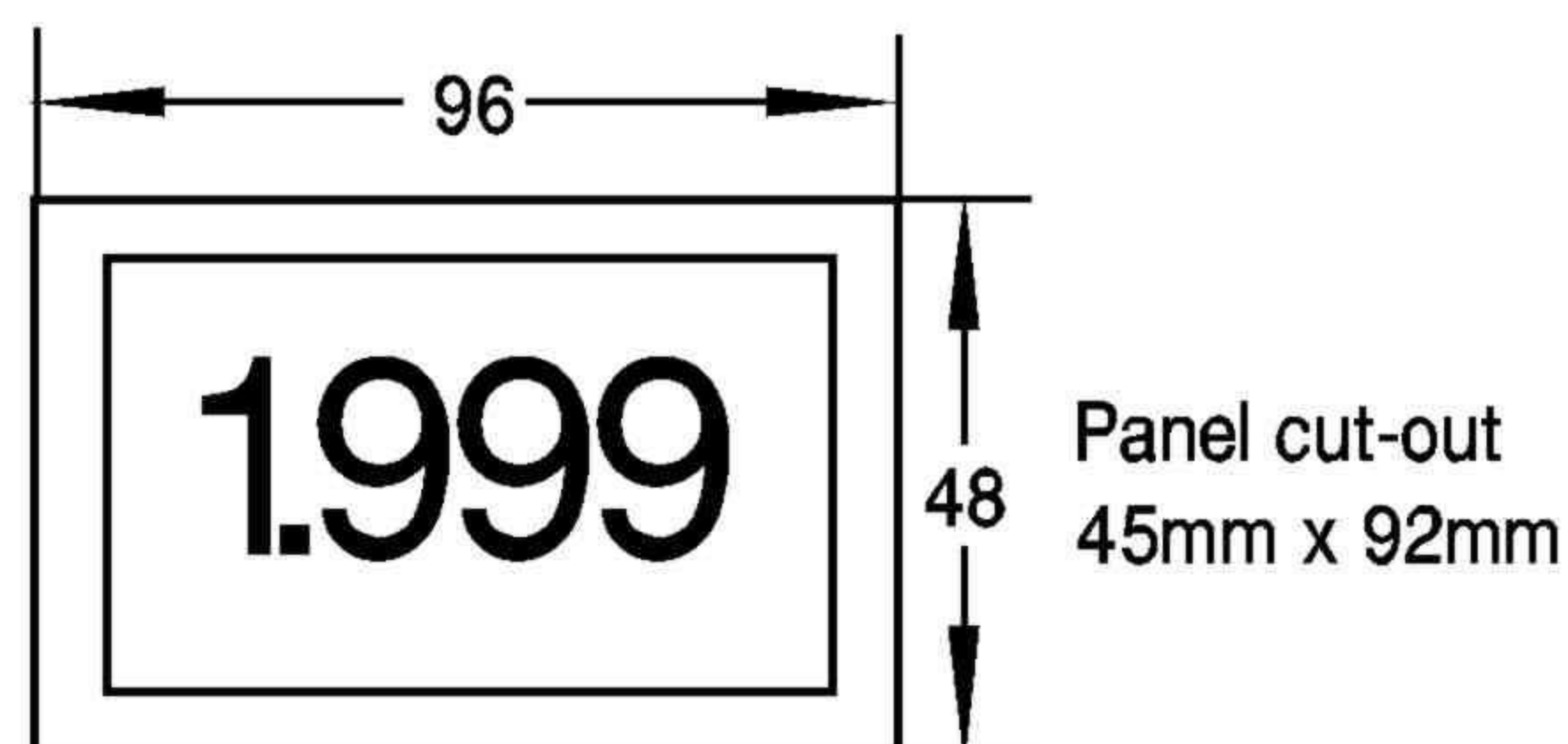

WIRING



11 = Loop earth

12 = Loop -ve

13 = Loop +ve

Customer marking

There is a removable red translucent panel at the front of the unit that can be silk screened or engraved to suit the application.

Tel: 01908-567003 E-Mail: sales@amelec-uk.com www.amelec-uk.com Fax: 01908-566735

AMELEC INSTRUMENTS , Cochran Close, Crownhill, Milton Keynes
MK8 0AJ.