

AGS1131 Air Ingress Timer

- Suitable for Air Ingress Timing
- Long battery life
- Amelec standard 2 years warranty
- EMI, RFI IP68 Enclosure

APPLICATION

Air Ingress Timer

TECHNICAL SPECIFICATION

FUNCTION

On power up, the OFF timer starts timing, once it reaches the set time on the OFF DIL switch, the valve is Opened and the ON timer started. When the ON timer reaches the set time on SW1, the valve is closed and the timers are reset. The cycle continues until switched off.

VALVE

Compatible with gases and mild liquids.
Gives consistent performance for the operating life.
Operating pressures up to 7 psig.
Connections: 1 x Inlet 1 x Outlet

CONTROLS

1. SW1 & 2 only one switch permitted at any one time.
2. SW3 - Test switch will confirm power and clock function by test LED flashing @ 1Hz.
3. SW3 - Reset switch will reset the timers.
4. To open and close value manually, set all switches of SW1 and SW2 to off. Using SW2 -NC switch turn valve On/off.

SW3- CONTROL		SW2-OFF TIME		SW1-ON TIME	
10	POWER	10	55 min	10	26 Sec
9	RESET	9	48.5	9	22
8	TEST	8	42	8	18
7	OFF TIME x 2	7	35.5	7	14
6	DEFAULT	6	29	6	10
5	OFF TIME X 0.5	5	22.5	5	6
4	ON Time x 2	4	16	4	4
3	DEFAULT	3	9.5	3	2
2	ON Time x 0.5	2	3	2	1
1	ON Time x 0.25	1	NC	1	NC

PERFORMANCE

Valve Pressure: 7 psig Max.
Battery life up to 5 Years
Accuracy: < ±2 %
ON time setting resolution: 2 Sec
OFF time setting resolution: 6 Min

Batteries (Not supplied)

5 x Lithium Non-rechargeable Batteries, 10 yr storage capability - self-discharge (1% or less per year) - 3.6V / 2600mA per Hr.



Customer connection - OUT LET (LHS) / IN LET (RHS).
Outer Dia = 4mm, Inner Dia = 2mm.
To avoid any damage to the IN & OUT LET adaptor points & surrounding seal, care must be taken not to put too much stress when inserting the tubes.

FUNCTION BLOCK DIAGRAM

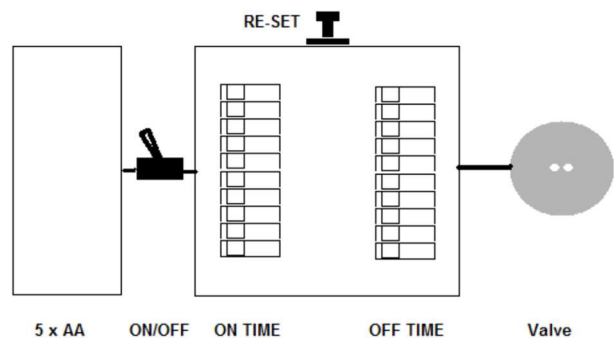

ENVIRONMENTAL CONDITION

Storage temperature: - 20 to +70 °C
Operating Ambient: -15 to +55 °C
Relative Humidity: 5 to 95% RH

DIMENSION

Enclosure: 120w x 100h x 36d (mm). For More details on page 2.
Weight < 0.5kg

ENCLOSURE PROTECTION

Designed with EMI/RFI seal which maintains conductivity between the lid and box, a watertight seal for up to IP68.

Important: Case must be earthed to ensure protection against RFI / ESD.

AGS1131 Air Ingress Timer

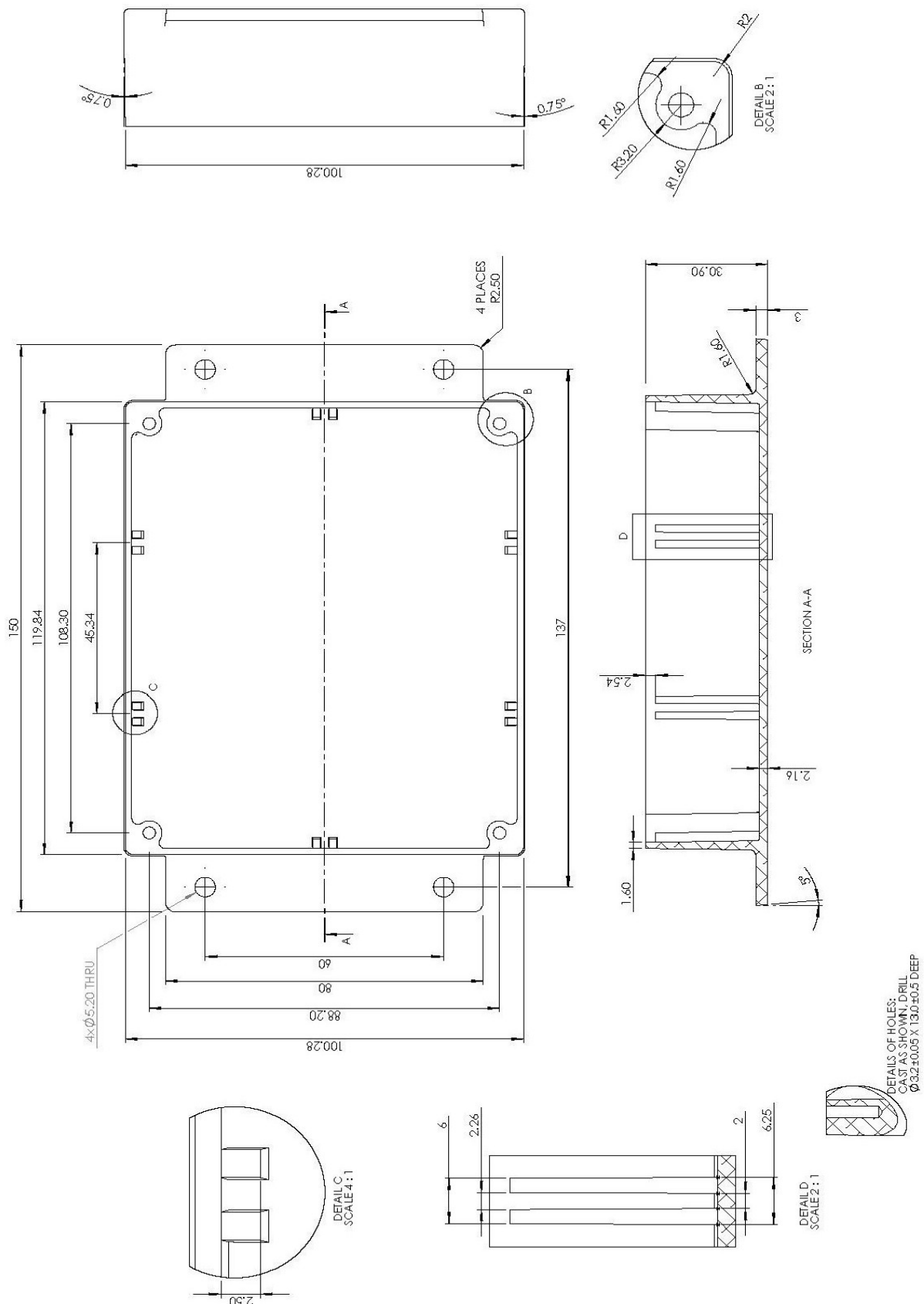

Optional AGS1131-IP69 Enclosure



IP69 rated weatherproof enclosure suitable for outdoor installations. It is resistant to UV radiation and is protected against rain and saltwater, as well as being temperature and impact resistant. This junction box is ideally suited to offshore applications.

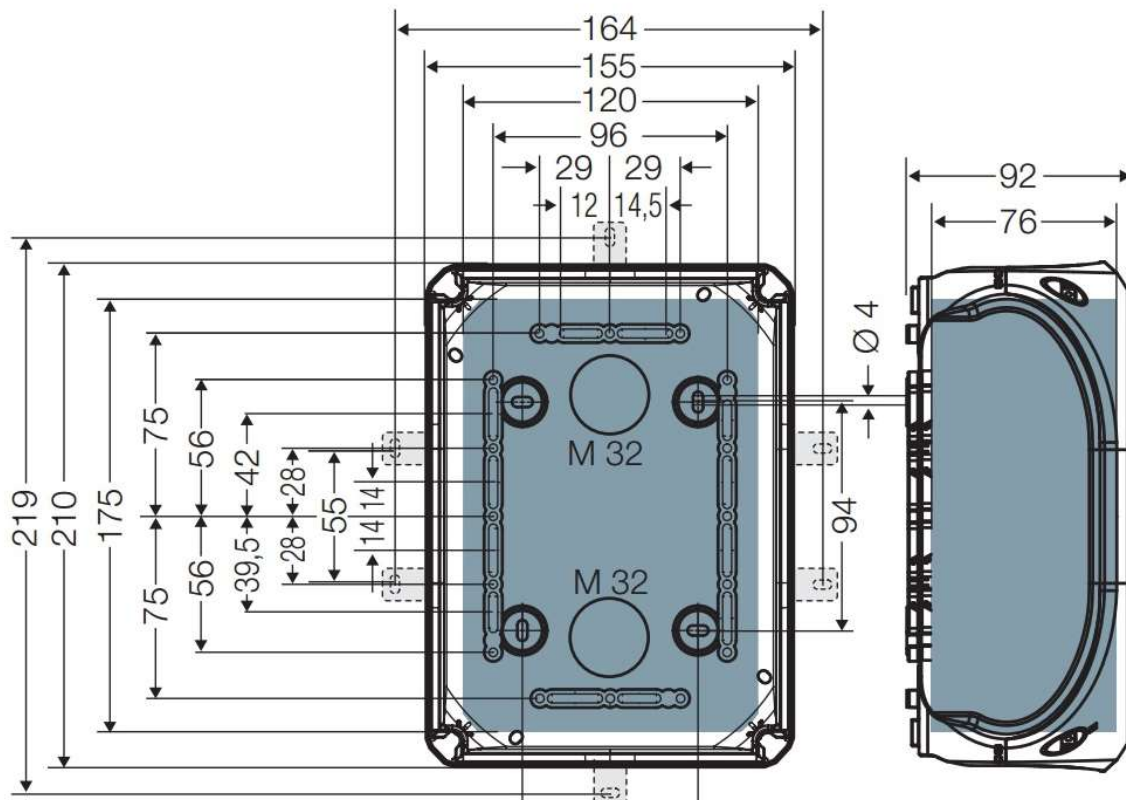

Tel: 01908-567003 Email: sales@amelec-uk.com Visit: www.amelec-uk.com Fax: 01908-566735
AMELEC Instruments, Cochran Close, Crownhill, Milton Keynes, MK8 0AJ